

POWERTILT[®]

Position your Bucket
not your machine.

Tilt any bucket
or attachment
up to 180°



ENGINEERING YOUR SUCCESS.

POWERTILT®

Perform Work Faster, Safer and Easier with PowerTilt®

Tilt any bucket or attachment up to 180° with our exclusive sliding spline technology. Increase productivity by 50% by simply tilting your attachment instead of moving the entire machine.



Coupler Options

All PowerTilt models come with a standard half-hitch coupler. Coupler options vary by model.

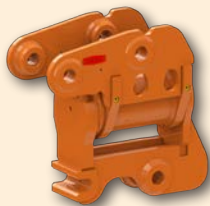

Standard pin-on

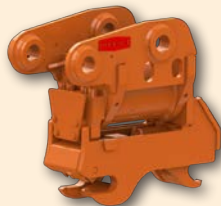

Hydraulic Pin Grab

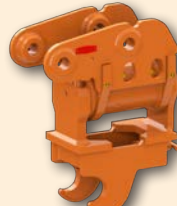

Universal

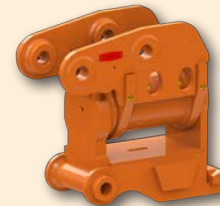

Brand specific



Custom

Reference Guide	PT-6	PT-6W	PT-7	PT-8	PT-9	PT-10	PT-11	PT-12
Maximum Machine Weight (lb)	8,400	10,500	15,000	20,000	30,000	50,000	60,000	75,000
Approx. PowerTilt Weight (lb)	160	180	320	425	575	850	1,200	1,500
Total Tilt	180° *	180° *	180°	180°	134°	134°	134°	134°
Required Oil Flow (gpm)	.8 - .15	.8 - .15	1.5 - 3	3 - 5	6 - 7	6 - 8	8 - 11	9 - 13

Note: A two-way auxiliary hydraulic circuit is required for operation. *Actual rotation may vary slightly.



Parker Hannifin Corporation Helac/Cylinder Division 225 Battersby Avenue Enumclaw, WA 98022 USA
 U.S. and Canada 800.PWR.TILT Worldwide 360.825.1601 Email attachments@helac.com Web www.helac.com

© 2017 Parker Hannifin Corporation U.S. Patent #4906161; Europe #356738; Japan #2614922

08/17 / HY34-1050